

## MOISTOP<sup>®</sup> 250 HEAVY WEIGHT CONCRETE UNDERLAY (PREVIOUSLY MOISTOP<sup>®</sup> 759)

### Application

Moistop<sup>®</sup> 250 (previously known as Moistop<sup>®</sup> 759) is a heavy weight, industrial strength concrete underlay designed to give permanent protection against ground water penetration in residential, commercial and industrial concrete slab applications. It can also be used as a ground cover membrane over damp sub-floors in suspended timber floor construction.

### Features and Benefits

- Pink facing (rather than standard black) - for ease of identifying tears and unintentional penetrations.
- Extremely tough moisture and water proof barrier – for continual moisture protection in harsh conditions
- High strength and tear resistance properties - to resist penetration from below
- Three layer co-extruded virgin polyethylene laminate - to increase resistance to vapour transmission and UV light
- 4m wide rolls - to minimise joins

### Product Description

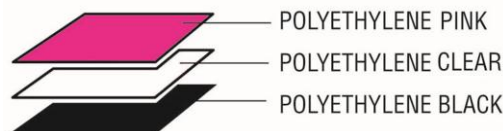

### Technical Data

NZS 3604:2011 Classification	Requirement	Performance
Vapour Barrier	> 90 MN.s/g	Pass
Dart Impact Test	> 800 g	Pass
Thickness	100µm	250 µm

Also meets requirements of NZS 4229: 1999 Section 7.4.1 and 7.6.1(a)

### Installation

#### General

- Moistop<sup>®</sup> 250 should be installed over a properly prepared compacted gravel base in accordance with NZS 3604:2011 Section 7.5.3 to 7.5.6.2. Sand at no greater than 25mm depth may be used to blind coarser gravels
- Moistop<sup>®</sup> 250 should be laid with the **pink** side facing upwards to enable easy inspection of taped joints and allow tears and unintentional penetrations to be quickly identified
- Moistop<sup>®</sup> 250 shall be joined with 150mm minimum laps and sealed with a 48mm pressure sensitive PVC joining tape. To ensure a good seal, apply a firm pressure over the lapped seam.
- Moistop<sup>®</sup> 250 shall be installed beneath any damp proof course (DPC) used to protect timber
- All repairs to be carried out prior to concrete pour. Tears or penetrations are to be repaired by applying a Moistop<sup>®</sup> 250 patch with at least a 150mm overlap on all sides to cover the tear/penetration.
- Moistop<sup>®</sup> 250 must not be left permanently exposed. All above-ground material must be covered

#### Sub floor Installation

- Moistop<sup>®</sup> 250 may be used to cover damp sub floors beneath suspended timber floors.
- Site must be cleared of debris and sharp objects.
- Cross slit for any penetrations such as jack studs, pipes or similar
  - cut to the nearest edge of Moistop<sup>®</sup> 250
  - patch slits with at least a 300mm overlap and seal with a 48mm PVC pressure sensitive tape.
- Avoid storing items on top that may puncture the material.

**Suggested detail additional to those in NZS 3604:2011 Figure 7.13**

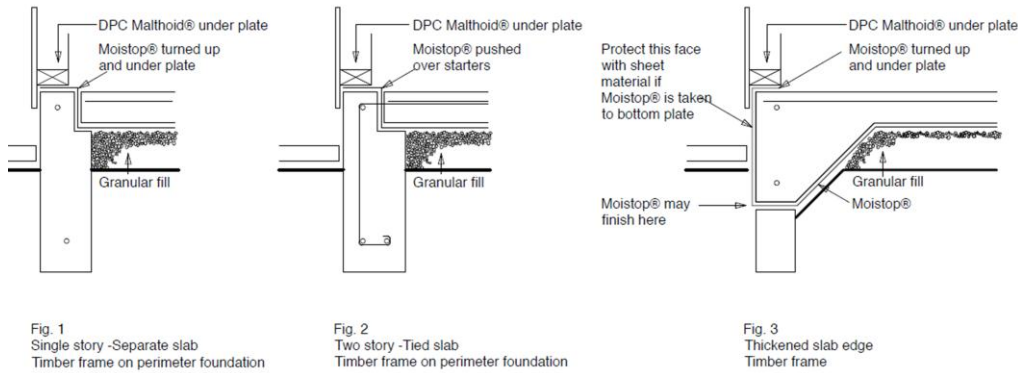

**Limitations**

Moistop® 250 **must** be:

- Installed on a granular base that will not puncture the Moistop® 250 as described in NZS 4229:1999 Section 7.3.2 and 7.6.2
- Installed with pink side facing upwards
- Taped on all joins and around all penetrations and patches

Moistop® 250 **must not** be:

- Left exposed for more than 28 days. All above-ground material must be covered
- Penetrated by pegs holding boxing in place for slab perimeters

**Durability**

When used, installed and maintained in accordance with the requirements outlined in this datasheet, Moistop® 250 will meet or contribute to meeting the following provisions of the New Zealand Building Code Clause B2 Durability B2 3.1 (a) (50 years) and B2 3.1 (b) 15 years when covered within 28 days of laying.

**Specification Notes**

**Product required:** Moistop® 250 concrete underlay (250 micrometers)

**Product Specification**

*Product Previously known as Moistop® 759*

Description	Product Code	Roll Size	Area	Nominal gsm
Moistop® 250	775910	4000mm x 25m	100m <sup>2</sup>	230

**Storage**

Moistop® 250 must be protected against damage and weather. Rolls must be stored on end, under cover in a clean, dry environment. Product must be protected from sharp objects.

**Accreditations/Appraisals/Certification**



Distributed by:  
Tasman Insulation New Zealand Limited  
9-15 Holloway Place,  
Penrose, Auckland,  
New Zealand

(1) This data sheet may have been superseded. Please refer to www.pinkbatts.co.nz for the most current information. This datasheet supersedes all previous versions. (2) Tasman Insulation New Zealand Ltd retains the right to change specifications without prior notification. (3) Do not use this product for any application not detailed in this data sheet. (4) Recommendations and advice regarding the use of this product are to be taken as a guide only. The purchaser should ascertain the suitability of this product for the particular end-use situation intended and when used in conjunction with other products. (5) Consult Tasman Insulation New Zealand Ltd for further information. (6) All claims about this product are subject to any variation caused by normal manufacturing process and tolerances. (7) The liability of Tasman Insulation New Zealand Ltd and its employees and agents for any errors or omissions in this data sheet or otherwise in relation to the product is limited to the fullest extent permitted by law. Except where the consumer acquires the goods for the purposes of a business, any rights a consumer may have under the Consumer Guarantees Act are not affected. (8) This information is provided without prejudice to Tasman Insulation New Zealand Ltd standard terms and conditions of sale.

*Please consider the environment before printing this document*

For further information visit [www.pinkbatts.co.nz](http://www.pinkbatts.co.nz) or call 0800 PINK BATTS (746 522)